

Style 型式

Specification 規格

METAL SHAFT

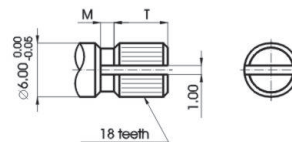
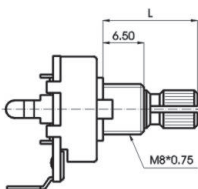
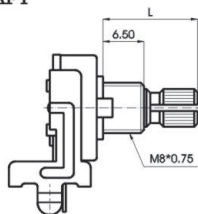

KQ TYPE:

| | | | | | | |
|---|-----|----|----|--|--|--|
| X | 2 | 3 | 4 | | | |
| L | 15 | 20 | 25 | | | |
| T | 6 | 10 | 12 | | | |
| M | 1.5 | 2 | 4 | | | |

INSULATED SHAFT

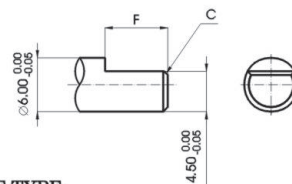
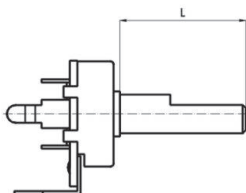
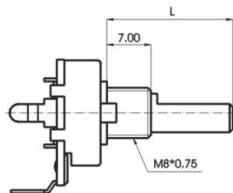
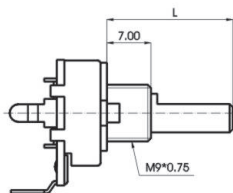

F TYPE:

| | | | | | | | |
|---|-----|-----|-----|-----|-----|-----|-----|
| X | H | F | A | B | C | D | E |
| L | 4 | 10 | 15 | 20 | 25 | 30 | 35 |
| F | 3.7 | 7 | 12 | 12 | 12 | 12 | 12 |
| C | 1 | 0.5 | 0.5 | 0.5 | 0.5 | 0.5 | 0.5 |

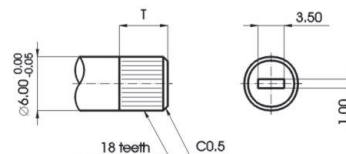

T TYPE:

| | | | | | | | | |
|---|----|----|----|----|----|----|--|--|
| X | L | M | V | O | P | Q | | |
| L | 10 | 15 | 20 | 25 | 30 | 35 | | |
| T | 8 | 12 | 12 | 12 | 12 | 12 | | |

R1613N-

R1612N-

R1614N-

R1616N-

Mechanical characteristics: 機械的性能

| | |
|------------------------------------|-----------------------------|
| Total rotational angle 全迴轉角度 | $300^{\circ} \pm 5^{\circ}$ |
| Rotational torque 迴轉扭力 | 2~15mN.m (20~150gf.cm) |
| Rotation stopper strength 止迴轉強度 | 0.6 N.m (6kgf.cm) |
| Push pull strength 軸推拉強度 | 50N (5kgf) |

Electrical characteristics: 電氣的性能

| | |
|--------------------------------------|---|
| Total resistance 總阻值 | 5K Ω ~2M Ω |
| Total resistance tolerance 總阻值容許差 | $\pm 20\%$ (more than 1M Ω $\pm 30\%$) |
| Rated power 定格電力 | curve B:0.1W other than B:0.05W |
| Max. operating voltage 最高使用電壓 | curve B:100V other than B:50V |
| Resistance taper 阻值線性 | A, B, C, W |
| Residual resistance 殘留阻值 | $R \geq 250K\Omega$ 0.1% max. of total resistance 250K Ω > R > 10K Ω 20 Ω max. 10K Ω \geq R 10 Ω max. |
| Insulation resistance 絕緣抵抗 | more than 100M Ω at DC 250V |
| Withstand voltage 耐電壓 | for 1 minute or more at DC 250V |

Durability: 耐久的性能

| | |
|-------------------------|---------------|
| Rotational life 迴轉壽命 | 15,000 cycles |
|-------------------------|---------------|